



360



362



364



364



365



366



367



367



367

Plumbing
650

Plumbing

Spanish Type Pipe Wrenches



650

Professional Spanish Type Pipe Wrench

Cr-V

60HRc

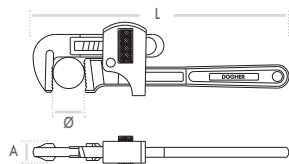

L mm	L "	Ø mm	Ø "	A mm	Part N°	€
200	8	25	1	11	650-200	27,21
250	10	35	1.3/8	15	650-250	36,08
300	12	44	1.3/4	17	650-300	41,52
350	14	50	2	19	650-350	45,88
450	18	60	2.3/8	23	650-450	62,02
600	24	76	3	26	650-600	100,92
900	36	102	4	30	650-900	207,54

655

Professional Aluminium Pipe Wrench

Cr-V

60HRc

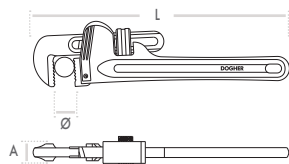

L mm	L "	Ø mm	Ø "	A mm	Part N°	€
250	10	49	2	17	655-250	49,89
350	14	60	2.3/8	21	655-350	66,48
450	18	76	3	26	655-450	95,05
600	24	89	3.1/2	28	655-600	140,89
900	36	140	5.1/2	32	655-900	280,81
1210	48	168	6	36	655-1210	453,85

651

Spare moving Jaw

CrV

Suitable for
650



L mm	L "	Part N°	€
200	8	651-200	12,88
250	10	651-250	18,21
300	12	651-300	19,84
350	14	651-350	20,99
450	18	651-450	27,46
600	24	651-600	43,24
900	36	651-900	72,49

652

Spare Nut

CrV

Suitable for
650



L mm	L "	Part N°	€
200	8	652-200	9,04
250	10	652-250	9,58
300	12	652-300	9,59
350	14	652-350	9,95
450	18	652-450	10,46
600	24	652-600	15,04
900	36	652-900	25,58

656

Spare moving Jaw

CrV

Suitable for
655



L mm	L "	Part N°	€
250	10	656-250	17,72
350	14	656-350	27,17
450	18	656-450	30,21
600	24	656-600	47,57
900	36	656-900	93,81

658

Spare Nut

CrV

Suitable for
655



L mm	L "	Part N°	€
250	10	658-250	9,58
350	14	658-350	9,95
450	18	658-450	10,46
600	24	658-600	15,04
900	36	658-900	25,58

657

Spare fixed Jaw

CrV

Suitable for
655



L mm	L "	Part N°	€
250	10	657-250	15,60
350	14	657-350	17,11
450	18	657-450	20,38
600	24	657-600	28,55
900	36	657-900	33,77

Plumbing

Spanish Type Pipe Wrenches



654

Professional 90° Degree Pipe Wrench

CrV

60HRc



L mm	L "	Ø mm	Ø "	A mm	Part N°	€
350	14	60	2	22	654-350	69,97
450	18	76	2.1/2	25	654-450	104,46

654M

Spare moving Jaw

CrV

Suitable for
654



L mm	L "	Part N°	€
350	14	654M-350	18,91
450	18	654M-450	21,22

654F

Spare Fixed Jaw

CrV

Suitable for
654



L mm	L "	Part N°	€
350	14	654F-350	11,84
450	18	654F-450	15,44

655

Professional Flexible Pipe Wrench

CrV

60HRc



L mm	L "	Ø mm	Ø "	A mm	Part N°	€
250	10	49	3/8-1.1/2	17	655-001	86,35

672

Professional Hawk Type Pipe Wrench

Cr-V

60HRc

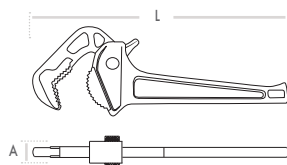

L mm	L "	Ø mm	Ø "	A mm	Part N°	€
200	8	6-19	1/4-3/4	14	672-200	45,23*
250	10	10-25	3/8-1	17	672-250	53,19*
450	18	25-51	1-2	28	672-450	133,66*

* Until end of stock

673

Professional Aluminium Hawk Pipe Wrench

Cr-V

60HRc

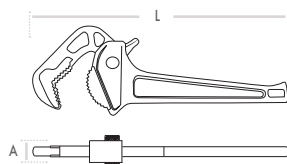

L mm	L "	Ø mm	Ø "	A mm	Part N°	€
250	10	10-25	3/8-1	17	673-250	68,65*
300	12	13-32	1/2-1.1/4	20	673-300	83,02*
350	14	13-38	1/2-1.1/2	24	673-350	89,93*

* Until end of stock

Plumbing

Basin, Radiator Step & Pipe Wrenches / Reversible Square Drive Ratchet



673 Basin Wrench

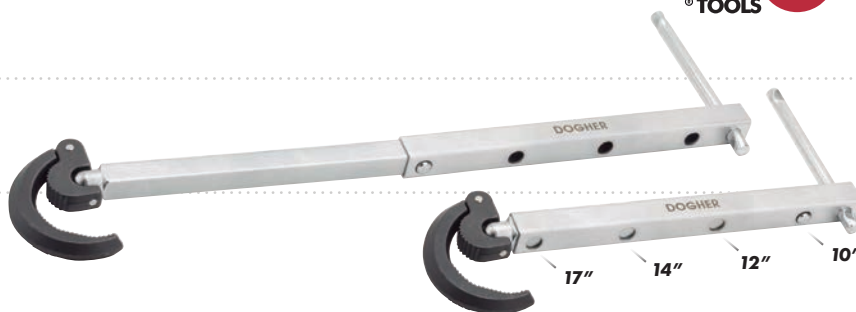
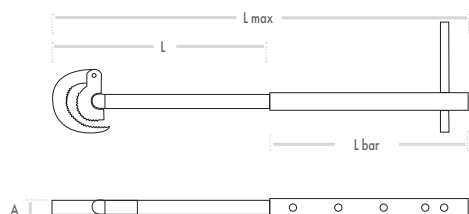

mm	L mm	L max	L bar	A mm	Part N°	€
10-32	230	460	230	15	673-001	49,10*
25-50	240	460	230	15	673-002	53,30*

* Until end of stock

660 Professional S Type Bent Nose Pipe Wrench

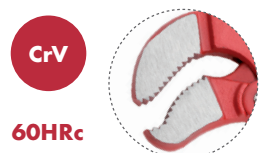

L mm	Ø mm	Ø"	Part N°	€
320	45	1	660-320	36,05
425	60	1. 1/2	660-425	47,91
550	75	2	660-550	76,16
630	120	3	660-630	112,14

661 Professional 90 Degree Straight Nose Pipe Wrench



L mm	Ø mm	Ø"	Part N°	€
320	45	1	661-320	35,88
425	60	1. 1/2	661-425	47,70
550	70	2	661-550	75,83
630	110	3	661-630	111,65

544 Reversible Square Drive Ratchet



L mm	Part N°	€
260	544-011	101,82

554 Reversible Square Drive Ratchet



L mm	Part N°	€
510	554-011	211,99*

* Until end of stock

544 Radiator Step Wrench

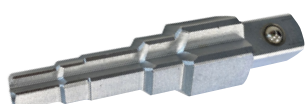

- 9,5 · 11 · 12,7 · 16 · 21 mm
- 3/8" · 7/16" · 1/2" · 5/8" · 13/16"

L mm	Part N°	€
90	544-022	19,93

662 Professional Chain Pipe Wrench

CrV



L mm	Ø mm	Part N°	€
300	90	662-001	53,42

662 Spare Chain

Suitable for
662-001



L mm	Part N°	€
300	662-001R	20,05

662 Professional Belt Pipe Wrench

CrV



L mm	Ø mm	Ø "	Part N°	€
300	75	3"	662-002	49,93
300	200	8"	662-003	63,32

662 Spare Belt

Suitable for
662-002 / 662-003



L mm	Part N°	€
450	662-002R	19,08
1.040	662-003R	23,99

662 Multipurpose Tube Bender

• For 6-8-10 mm Tubes

Part N°	€
662-020	42,36



Plumbing

Tube Cutter



665

Multilayer and Plastic Tube Cutter



Position 1 **Ø27mm**

Position 2 **Ø45mm**



Ø mm	Part N°	€
0~45	665-45	73,48

- To cut polyethylene, Ppr, multilayer.....
- Cutting capacity selection pin (27 a 45 mm)
- Forged and tempered Steel Blade.

667

PVC Pipe Cutter Manual Return



Ø mm	Part N°	€
0~36	667-36	39,10

675

Zip Action Tube Cutter



Ø mm	Part N°	€
3~28	675-03-28	30,79

- Includes Spare Blade

* See HSS Blades in page 368.

675

Zip Action Tube Cutter



Ø mm	Part N°	€
3~32	675-03-32	26,33

- Includes Deburring Tool

* See HSS Blade in page 368.

675

Zip Action Tube Cutter



Ø mm	Part N°	€
3~41	675-03-41	49,66

- Includes Spare Blade

* See HSS Blade in page 368.

675

Zip Action Tube Cutter

- Cu
- Al
- Inox



* See HSS Blade in page 368.

Ø mm	Part N°	€
6-65	675-06-65	104,60

• Includes Deburring Tool and Spare Blade

675

Mini Zip Action Tube Cutter

- Cu
- Al
- Inox



* See HSS Blade in page 368.

Ø mm	Part N°	€
3-16	675-03-16	15,72

• This tube cutter includes one blade which is able to cut non-ferrous materials as aluminium and bronze (but specially copper and stainless steel) even if there are available specific blades for each application.

676

Auto Tube Cutter Zinc Body

- Cu
- Al
- Inox

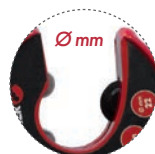

Ø mm	Part N°	€
10	676-10	29,77
12	676-12	30,82
15	676-15	33,95
18	676-18	36,51
22	676-22	36,74

677

Pipe Deburring Countersink

- Cu
- Al
- Inox



Int.

Ext.

Ø mm	Part N°	€
3-40	677-03-40	21,64

• This tube cutter includes one blade which is able to cut non-ferrous materials as aluminium and bronze (but specially copper and stainless steel) even if there are available specific blades for each application.

Plumbing

Tube cutter Spare Parts



665

Spare Blade

Suitable for
665-45



Ø mm	Part N°	€
0~45	665-45R	17,79

667

Spare Blade

Suitable for
667-36



Ø mm	Part N°	€
0~36	667-36R	10,17

675

Spare Blade

Suitable for
675-03-28 / 675-03-32 / 675-03-41



Material	Application	Part N°	€
HCS	Co · Al · Bronze	675-04AC	4,79
HSS	Inox	675-04HSS	6,12

675

Spare Blade

Suitable for
675-06-65



Material	Application	Part N°	€
HCS	Co · Al · Bronze	675-06-65AC	8,42
HSS	Inox	675-06-65HSS	15,77

675

Spare Blade

Suitable for
675-03-16



Material	Application	Part N°	€
HCS	Co · Al · Bronze	675-03-16AC	4,19